

# Gomptf

GOMPF BRACKETS, INC.  
 1410 19th Ave. N.W.  
 Issaquah, WA  
 98027-8923  
 Phone: (425)391-0495  
 Fax: (425)391-0496

**COPYRIGHT PROTECTED**

DWG. NO. 9673-0000

MATERIAL:  
 0.036 THK CRS

FINISH:  
 BRIGHT NICKLE

TOLERANCES:  
 STD. TOLS.  $\pm 0.010$   
 RAD. TOLS.  $\pm 0.010$   
 HOLE TOLS.  $\pm 0.005$   
 MAT. TOLS.  $\pm 0.002$

SCALE: 1:1

DATE: 9/18/00

REV. 0

ISSUED:

APPROVALS:

DRAWN BY: VW

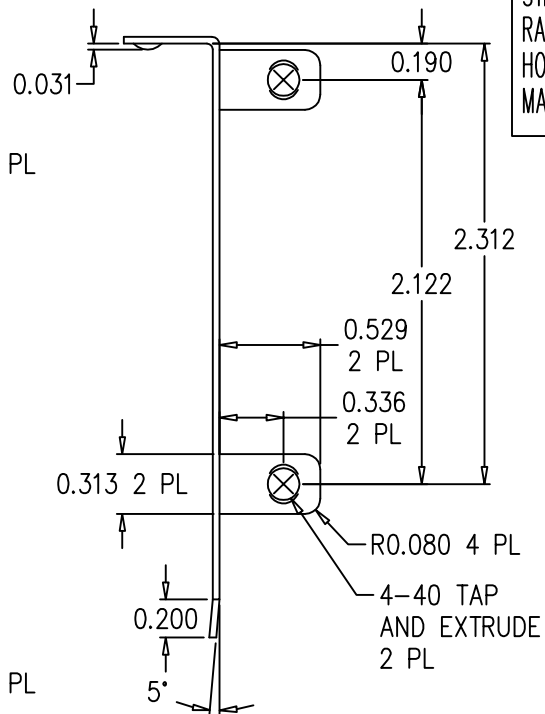
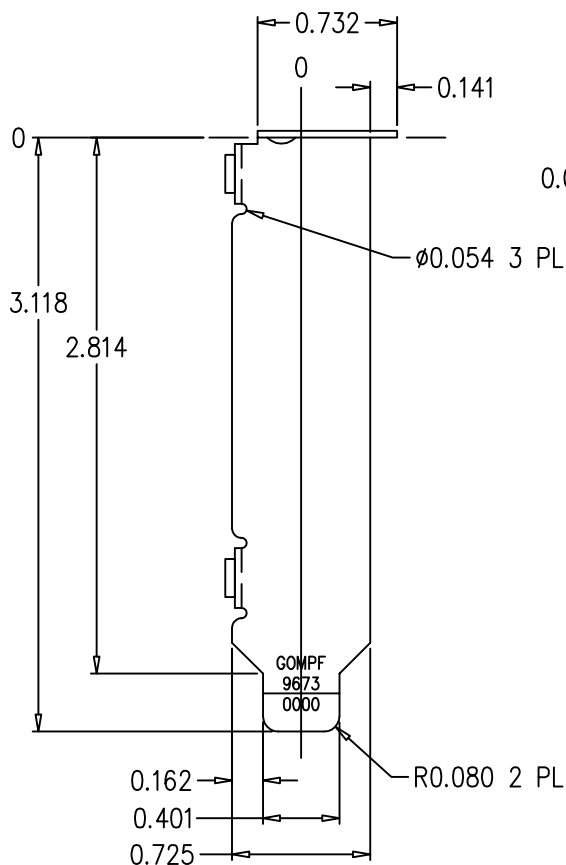
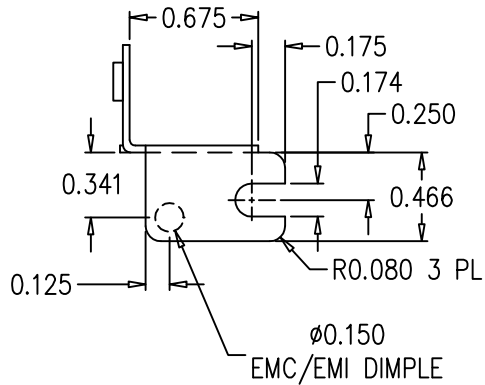

NOTE: BRACKET BASED OFF OF PCI SPECIFICATION REV 2.2